

Wheel of Fortune

- Fool + Fortune Wheel = lucky Pair
- Emperor + Hermit = Royal Pair
- Lovers + Fool = lucky Pair
- Judgment + Justice = Council Pair
- Tower + Lovers = low Pair
- ✓ Moon + Star = Astral Pair
- Fool + Tower = low
- Fool + Mag = High Pair
- Emperor + Hermit = Royal Pair
- Justice + Hiero = Justice
- Fortune + Hanged = lucky
- ~~Hermit + Emp~~
- Christ + Hanged = Mortal
- High Priestess + Devil = Dark Pair
- ✓ Empress + Hermit = Royal

Dark Pair beats Council Pair

- Lucky Pair beats Death
- Council Pair beats Magician
- lucky Pair beats Low Pair
- low Pair beats Devil
- Astral Pair beats low Pair
- High Pair beats Devil
- Royal P beats low P
- Council Pair beats Death
- lucky Pair beats Mag
- Royal P beats Mortal
- Dark P beats Justice
- Death beats Moon
- Death beats Star
- Mag beats Devil
- Hiero beats Devil

<u>Astral</u>	<u>Royal</u>	<u>Dark</u>	<u>Lucky</u>	<u>Justice</u>	<u>Council</u>	<u>Low</u>	<u>Mortal</u>
Moon	Hermit	High P	Fortune	Judgment	Tower	Christ	Hanged
Star	Emperor	Devil	Hanged	Justice	Lovers	Hanged	Hanged
World	Empress		Lovers	Hiero	Fool		
	Hiero		Fool				

High Priestess / Mag, Hiero / Devil / Death > Moon, Star

Temperance - WOOD / BRONZE / PAPER / SILVER / LEATHER / TURQUOISE

(anniversaries)

RED Y R N → Canopy

Canopy - a workbench

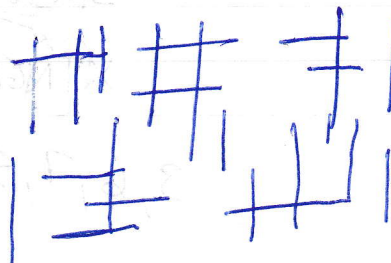

→ The Pygmy Boys
"BAD YAM"

3,1,

Righting Bars W

- ① ~~swap 1st + last~~ reverses all
- 2 'N-
- 3 G~~h~~-
- 4 E- -U
- 5 N-

NEW 4 GNU
~~NEW 4 GNU~~ → Stone Wall
~~NEW~~

↓ NEW 4 GNU
 → UW 4 GNEN

Manuscript

U
 E
 TTE N E O P R
 E
 H

The Emperor (word find)

The Enchantment

14-8-15

TN

- 1) -EE
- 2) -TEE
- 3) SI- / -N
- 4) X-
- 5) XT-
- 6) new
- 7) T₂ (SI)

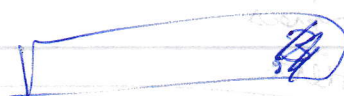

- SIXTEEN-SIXTEEN 3
- XTEEN-SIXTEEN 2
- XTEEN-SIX 5
- SIX- EEN-SIX 7 ✓
- EENTX 6
- XTNEE 4
- ~~SIXTEEN-SIX~~ TNEE 1
- XTNEET TN

3, 6, 7, 5

The Star "Mystical Chart" → The Stream
 NZSLTZMB HQZUU

The World → The Maze of Hedges

Empress

MISS
 TWIG
 IDBA
 ROOT

WEEP
 YOUR
 HAIR
 ARZA
 WORM
 IRON
 LARD
 SOUP

STAR PYRAMID

→ The Children

The Children CP

- 1) EΛ ARE-/-CA
- 2) ASTΛ-
- 3) W-/-RE
- 4) -SEΛW
- 5) HEΛL-/-BTHO
- 6) T-/-HO

2, 5, 4, 6, 1, 3

→ The Couple

SARDINE
 TROUT
 GOLDFISH
 HALIBUT
 MINNOW
 PERCH

N
 O
 S
 H
 I
 P

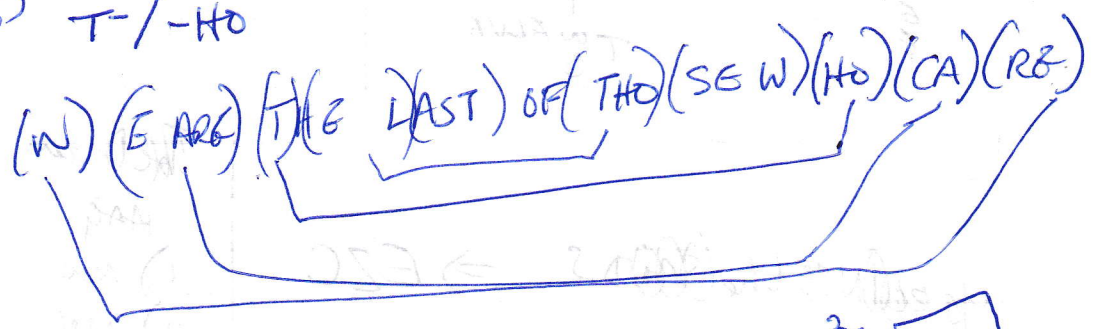

Behind the key of
 Tower

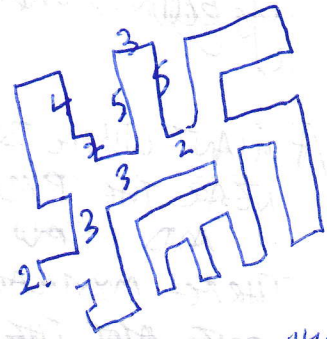
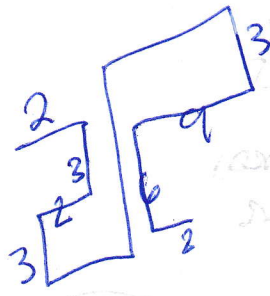
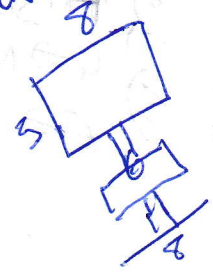

DEVIL = TO SECURE THAT WHICH
 CANNOT BE GOTTEN
 YOU MUST INVOKE THE
 POWERS OF A COMPASS
 AND CONVINCE IT
 TO COME TO YOU

ALAS I DO HE SIGHT / YOUR KNIGHT SAYS / THAT /
 NO SHIP HAS LANDED / UPON YOUR SHORE

TWO
 OIL
 END

Singer

are you (R) (E) (S) (L) (N) ✓ ⇒ BOW
 x x

Manuscript

T
 H
 FOURTEEN
 E
 E

T
 TWELVE
 O

3/4 (6/13) 1/19
 5/17 - 2/12

gaze into the SANDS ⇒ E Z C

A GIANT WHOSE STOOD
 NEAR THE PYRAMIDS
 AND I SAW
 THREE MYSTICAL WORDS
 ONE APO THE OTHER

The Dream

AAG

- 1) new
- 2) new
- 3) N- / -TBGNA
- 4) OSEGN- /
- 5) HEPB- / -G
- 6) FISE- / -TI
- 7) G ⇒ NU
- 8) E ⇒ φ

MUCH TO ACCOMPLISH ⇒ AIT

Temp + Justice?

~~Astral~~

- (Mortal) Strength + Anged
- (Dark) Death + Devil
- (Mortal) Shyem + Hermit
- Lucky Shows + Fortune
- (Asga) May + Fool
- (Dark) Devil + High P

~~Mortal Pair~~

- Mortal P vs H (36)
- Dark vs Royal (72)
- May vs HP (9)
- lucky 2 vs Her (27)
- Mortal 2 vs Devil (36)
- Royal 2 vs lucky 2 (45)
- My vs Devil (9)
- High 2 vs Astral (81)
- Council 2 vs Royal 2 (54)

- Hermit > Temp, Lovers
- HP > Tower, Emp
- May > Her, Anged
- Her > World, Fool
- Devil > Emp, Temp
- Devil > Shyem, Tower
- may > Hermit, Temp

	81	High Pair	(May, Fool)
	72	Dark	(Devil, High P)
	63	Astral ?	(Moon, Star, World)
126	54	Council	(Justice, Judgment, Her, Temp)
117	45	Royal Pair	(Emp, Emp, Hermit, Her)
	36	Mortal	(Hermit, Anged, Chariot, Str)
99	27	lucky	(Fortune, Lovers, Fool, Anged)
	18	Low ?	(Tower, Lovers, Fool, Chariot)
	9	Single	

Lucky Pair Anged Man up (Fortune + Anged)
 beils
 lucky Pair, Lovers up (Fool + Lovers)

AUT-2 und

$N / TE(NU)NA$
 $OSE(NU)N /$
 a

- 1,2) GAH
- 3) NHAGTEGNA
- 4) OSEGNHAG
- 5) HE_aSHAGG
- 6) HISEHAGTI
- 7) HANU
- 8) HAG

He_aS / NU
 a
 $HISE / TI$

- | | | | |
|--------|-----------------------|-----|-----------------------------|
| 3(1,2) | ANGETGAHN | 6,1 | ITGAHESIH |
| 4(1,2) | GAHNGESO | 6,3 | NHISEHAGTITEGNA |
| 5(1,2) | GGAHSAEH | 6,4 | OSEGNHISEHAGTI |
| 6(1,2) | IT GAHESIH | 6,5 | HE _a SHISEHAGTIQ |
| 7(1,2) | UNAH | 6,7 | HISEHANUTI |
| 1,3 | NGAHTEGNA | 6,8 | HISAHAGTI |
| 1,4 | OSEGNGAH | | |

- HE_aSANG_aTHIS_aHAUNTING 5
- ANG_aTHIS_aHAUNTING 1
- NITNUAH_aSIHT_aGNA 8
- NITNUAHESIHTEGNA 3
- ITNUAHESIH 7
- ITGAHESIH 2
- HISEHAGTI 6
- HAG

- 1,5
- 1,6
- 1,7
- 1,8
- 3,4
- 3,5
- 3,6
- 3,7
- 3,8

$(\frac{G}{NU})AN$
 $HAG(\frac{G}{NU})$

HISE	TI
AN $(\frac{G}{NU})$ eT	N
He _a S	G

He_aSANG_aNUETIISE $(\frac{HAUNTING}{HAG})$ (SONG)

④

(10 suit) Jura (3)
 Sages EG, LL, OC (10 words)
 Warriors (2) BOW (7 words)
 Pg of Wonders E (con pyramid)
 Stream NZSL TZMB HGZUU (8 words)
 Knight
 Wheel
 Archway
 Pyramids H (concrete pyramid)
 Curiosity (2) RED URN
 Frying Bays BAD YAM
 Store Wall NEW GNU
 Watchtower
 Queen
 The Ward

3 Ships (2) RW (1 and first of 6. Next sake he who chases a job)

II Hanged Man TOP
 Page of Cups (2) KD (job) - Seek she who holds two swords
 Kt of Cups - (Queen must be told no ship approaches)
 Children (2) (flowers in 6 vases)
 Couple (2) CARE (2 glasses - union of Ward & Cup) That is the work of the Devil and Despair - their work spoken & done.
 Dancers
 Family
 Not a Merchant
 Queen of Cups (2) YNAL (meyer word)
 The Cup T (Ace/King's cup?)
 The Cloud 6, 13 (4 of Cups) ~~fifteen / two of two / (7 cups)~~
 The Vision 15, 2, 20 (7 of Cups) ~~14, 15~~
 The Enchantress 14, 8, 15 (5 of Cups) ~~16, 16~~
 The Abandoned Cups 16, 16 (8 of Cups)
 Hierophant (2) 15, 24, 2
 The Moon (2)

"From others have come before you
 "The map shows you only of the places you have visited
 and never of the places you have not." - follow the past West

Farru ->

"I AM HERE AT THE QUEEN'S REQUEST"

Knight of Pentacles (2) TEHWA, ERCI, NCRO (seeds)

=> WHEAT, RICE, CORN ?

K, Q, W, Z

LSHAIVECIRCLE

VLSHAWK FIVECIRCLE

IV Empress WIF DOVE
Gyress VILE SHADOW, FIVE CIRCLE
Star ERR

High Pa (3)

Sentry

Kt of Swords

Chant

ECC

"Seek the family who departs by boat"

Dream (2)

(4 Swords)

"Agent wheel stood near the pyramids + I saw 3 mystical words, one also seen"

Nightmare (2)

(9 Swords)

"I saw a man carrying 10 wooden staffs. He sang thing having song again + again"

Q of Swords

The Sword

The Boat

Despair

Dead Warrior

Justice @ (2)

"To left the cause, the Gyress must simply like what is his from what is hers."

Pg of Swords

(UR) L17 D10 @ U8 R11 @ R4 D10 @ U6 L9 @

L -> R, R -> L, T -> B, B -> T

R6 U1 @ R3 U2 L2 U2 R2 U3 L3 U4 R7

D4

L3

D3

R2

D2

L2

D2

R3

EX

PUS

I am afraid that I am not the messenger you expect.

But I was told to warn you that two ships approach from the south.

ARM
TOO
EBB

Dream

"Bring A message
From your Knight
He Tells of An Attack
By 8 Magical Wards"

RAB
AWE
WEE

(UR)

Hamburg L17 D10 @ U8 R11 @ R4 D10 @ U6 L9 @

map alt

- shift shows what map been is what

It additional address on mp

1) Kingdom of Cup

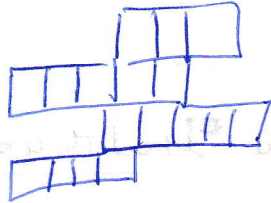

Secret Code -

if you know what is what,
enter the letters you want to switch

The Straight Path

Kingdom of Wands

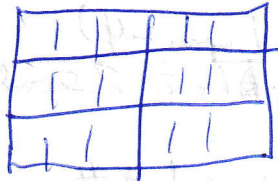

Kingdom of Swords

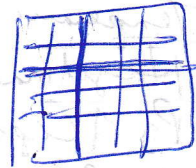

W3R ZURUR4UR (to drop the down)

L D3 R2 D R U RS

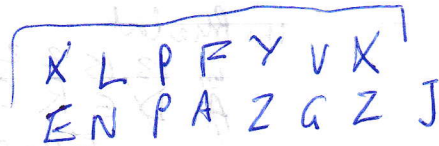

⇒ DIAMOND
BLACKJACK
(depends on sin map,
Kt of Swords,
Fuchant rest discs ??)



Fortune

ONO
ROR
DND

NZSLTZMB, H9ZOU

Juggler =
Farmer =

Kt of Pent TETHWA, ERCC, NCRO

Blacksmith AIH

Cathedral ROI

Chapel MYR

Hunting FIE

Merchant *I have only half a penny. *I read the words of the 4 who precede me

Moze of Wklyes -

Moze of Thorns *for if you had, most lord's lost treasures would be found.*

Queen of P TRSC (magic wood)

The P B

Pg of P *And once I have consulted o - 4 sages that await me, I shall be 1/2 way there

Words YES

Strength ERA

Temperance SIP

Hangedman TOP (at b/c of upper half)

Pg of Cups KD (seek the 2 swords)

Kt of Cups -

Children *the word of a star and *the word of the pyramids*

Compe CARE *That is the work of the Devil + Despair!

Dancers LEAP JOY

Family WISH *The food of fertile seeds*

Not a-M NINE

Q of Cups YNAL

The Cup T

Cloud 6, 13

Vision 15, 2, 20

Enchantment 14, 8, 15

Adam Cups 16, 16

Heav *For others have come before you 15, 24, 2

Moon *The map shows only where eyes are outside*

YES
ERA
SIP
TOP
AIH
ROI
MYR
FIE

YES
ERA
SIP
TOP

the blue text

G 13/15 2 20 14 8 15 16 16 15 24 2
A D E R O W F H L E M R

~~EMERALD FLOWER~~

EMERALD FLOWER

Ring	Swords	N	Map	Access	
			Q	S	BRONZE
			A	B	STATUE
			T	T	
			R	E	

TBWA, ERCI, NCRD

	Cup	Pert	Su	Un
Knights	-	-	-	*
Pages	K	-	-	E

From the swamp

DS4UTDOK
GOLD DUST

R&D	RAT
URN	IVY
BAD	NEW
YAM	GNU

Path of 6

RW/KD/EZC/YH/HA/RW

decided (between Y + Justice)

→ ON YX MEDALLION

Star ERR

Prisoners (inscript from town + letters from Death)

Sentry (blood of men killed by 10+ weapons of outd warriors)

Kt

Chart (EZC)

Dalam wheel new pyramids, 3 words atop each

Nitrate saw men 2 10 shells, Sing song

Queen (EKG)

Sword (G)

Boat (YH)

Despair GRIF

Dead warrior PUS (killed by 10)

Justice -

Pg of S 8 gents letters

Christ (HA)

QM	PJS
ZA	BOW
Eg	ONO
LI	ROR
OG	DNS

4N 7W 3N

8W 6S 5E 9N

4
← 2

JOY
GRIF
WABAT
RICE
LEAF
HAX
DEAD
CARG
ERR
CORN
WISH
NINE

DRBUPVYU (yellow on map)
AMETHYST

Circle

the Bog is a Dog
one Hog is a hAg
the ket is lit
one rod is rEd

O
*O
T^T*THOF*G
H*H
B
E*
K
THE BOOK OF THEH

2/1/19
2/1/19
2/1/19
2/1/19
2/1/19
2/1/19

2/1/19
2/1/19
2/1/19

2/1/19
2/1/19
2/1/19

2/1/19
2/1/19
2/1/19

2/1/19
2/1/19
2/1/19